

WILLPOS B20



WILLPOS B20

Retail Innovation For Your Business

OPTIONS



15"/12.1" TFT
(analog / LVDS)



Line display
(2 lines ANK/full-dot)



Operation unit
(keyboard with touchscreen TFT)



POS keyboard



Cash drawer



Cash drawer



Single thermal printer



Dual-sided thermal printer

The WILLPOS B20 and its options are also available in white.

| WILLPOS B20 | |
|-------------------|---|
| CPU | Celeron M 1.86GHz |
| Chipset | 945GME |
| Memory | 1GB DDR2 SODIMM (max. 4GB) |
| HDD | 2.5" HDD 120GB SATA I/F (max. 2 drives) |
| RAID | RAID 1 support (depending on model) |
| CD/DVD Drive | Integrated (option) |
| U-SSD I/F | Yes |
| Floppy Disk Drive | External drive USB I/F (option) |
| Display I/F | VGA (analog) (LVDS digital - option) |
| LAN | 10/100/1000BASE-TX |
| Audio | Lineout x 2 (front & rear), mic in x 1 (rear) |
| Speaker | Beep |
| PS/2 | Keyboard x 1, mouse x 1 (rear) |
| RS232C | 4 + 2 (option) |
| Normal USB | 3 (1 front, 2 rear) |
| Powered USB | 12V x 5 (rear), 24V x 1 (rear) |
| Drawer Port | 2 (Toshiba I/F) |
| Parallel | 1 (rear) |
| PCI Slot | 2 |
| Front LED | Disk, power, diagnostics |
| AC Outlet | 1 |
| Cabinet Colour | FW2 (Fair White2), CB (Cool Black) |
| Weight | 8.8kg (RAID model: 8.9kg) |
| Dimensions | 315(W) x 466(D) x 112.5(H) mm (with cable cover) 315(W) x 396(D) x 112.5(H) mm (without cable cover) |



The Toshiba WILLPOS B20 -
Retail Innovation For Your Business

All company and/or product names are trademarks and/or registered trademarks of their respective owners.
All features and specifications described in this brochure are subject to change without notice.

JINBODAU

TOSHIBA

TOSHIBA TEC AUSTRALIA PTY LTD
Unit 1, 9-11 South Street Rydalmere NSW 2116
T. +61(2) 8845 6222
F. +61(2) 9680 0892
sales@toshibatec.com.au
www.toshibatec.com.au

Direct from the Toshiba experts, an energy-saving yet powerful POS engine, specifically designed to reduce environmental impact. The innovative WILLPOS B20, with its quick and effortless 'slide-out' servicing, is the smart choice for today's eco-friendly retailers.



TOSHIBA
Leading Innovation >>>

Your TOSHIBA TEC Dealer:



WILLPOS B20

APPLICATIONS

As an energy efficient yet high performance modular POS solution, the WILLPOS B20 offers a powerful advantage across a variety of highly competitive retail markets.

- ▶ Supermarkets
- ▶ Hypermarkets
- ▶ Superstores
- ▶ Department stores
- ▶ Warehouse stores
- ▶ Wholesalers
- ▶ Service stations



TOSHIBA
Leading Innovation >>>

'SLIDE-OUT' SERVICEABILITY

We had a vision of the future and made it real. Enjoy.

With a wealth of long-term experience and knowledge, Toshiba consistently designs and manufactures its cutting-edge POS ranges from scratch, right down to the hinges.

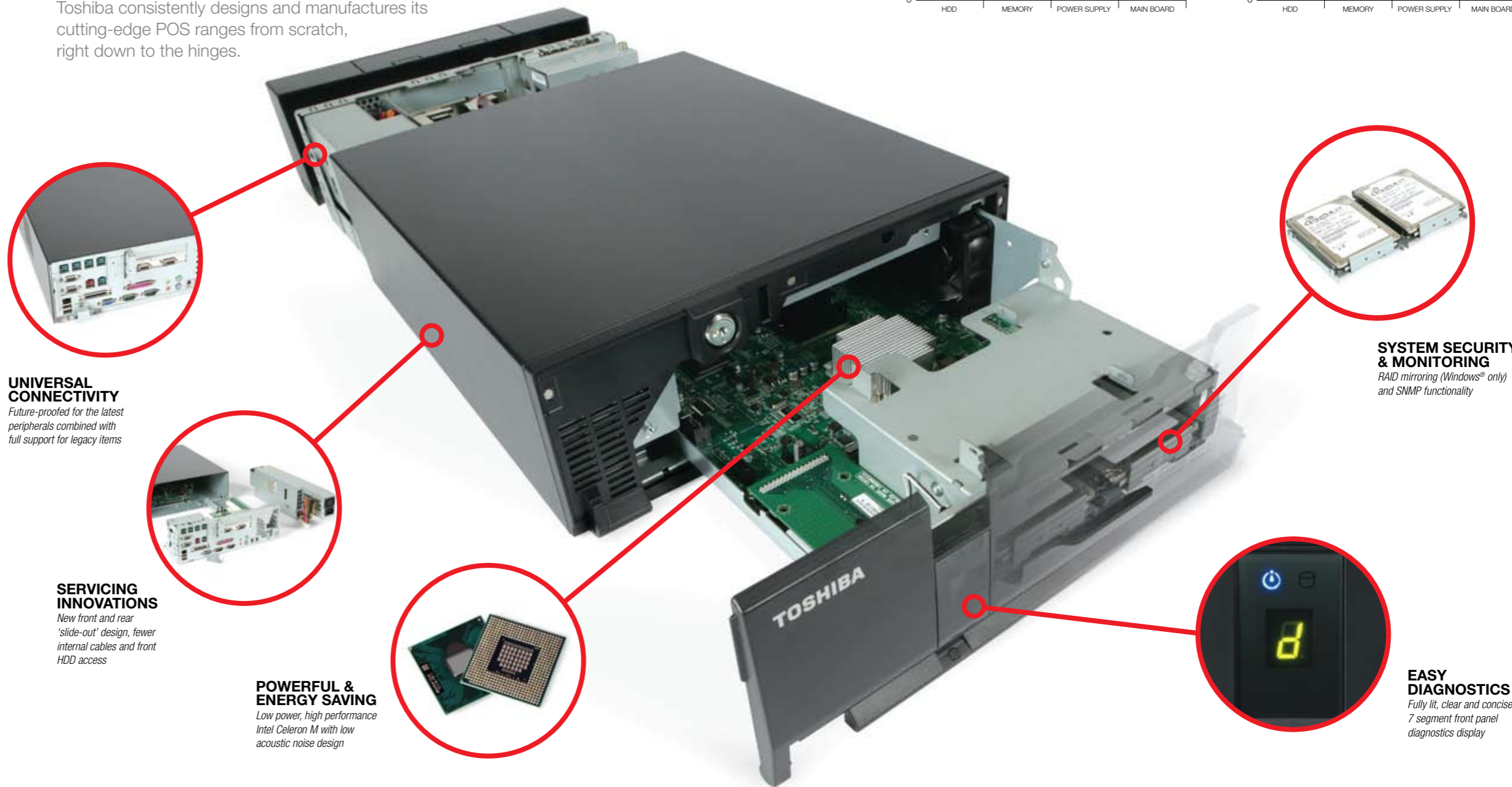

UNIVERSAL CONNECTIVITY

Future-proofed for the latest peripherals combined with full support for legacy items

SERVICING INNOVATIONS

New front and rear 'slide-out' design, fewer internal cables and front HDD access

POWERFUL & ENERGY SAVING

Low power, high performance Intel Celeron M with low acoustic noise design

SYSTEM SECURITY & MONITORING

RAID mirroring (Windows® only) and SNMP functionality

EASY DIAGNOSTICS

Fully lit, clear and concise 7 segment front panel diagnostics display

> EFFORTLESS MAINTENANCE

With front and back tool-less 'slide-out' components and fewer internal cables, servicing the WILLPOS B20 is quick and effortless, taking downtime to an absolute minimum and further reducing the total cost of ownership. It is also uniquely possible to remove the hard disk, motherboard and power supply without first detaching any peripherals.

Toshiba benchmark tests confirm that WILLPOS B20 servicing times are considerably quicker than its predecessor or its competitors. For example, to reach the main board, another modular POS requires 24 actions, yet the WILLPOS B20 needs just 4, and the total time taken to replace the main board in the WILLPOS B20 is at least 3 times faster than that of its two main competitors.

> ENHANCED FUNCTIONALITY

A unique 7-segment fully lit front panel display provides a quick reference system status, giving instant information on activity, states or diagnostics.

> CONNECTIVITY

The WILLPOS B20 offers superior connectivity, not only providing full support for legacy peripherals, but uniquely future-proofed for innovative new options.

> LESS ENERGY, MORE POWER

The innovative low-energy processor gives top-level POS performance whilst reducing running costs and CO² emissions. Tests show the WILLPOS B20 to use 49% less energy than its predecessor, the ST-7000, yet is an incredible 76% more powerful.

> RECYCLING PROGRAM

We collect and recycle our used units, re-processing them for re-use.

> GREEN MACHINE

We work to strict ecological policies to benefit both the environment and our customers.

- Recyclable chromium-free metal
- Recyclable halogen-free plastic
- Packaged in recyclable paper products
- Built and supported for a long life cycle
- Design and manufacturing on ISO14001

COMPETITOR
COMPETITOR
ST-7000
WILLPOS B20

Number of Processes To Reach Each Part

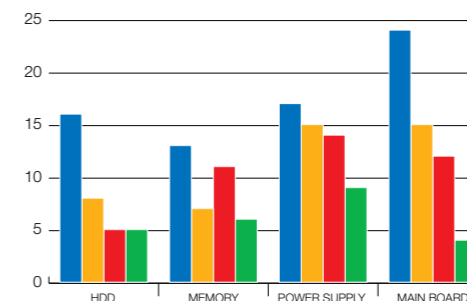

Estimated Time To Replace Each Part

